





wall decal (random pattern) INSTALLATION INSTRUCTIONS

- 1 In order for your decal to stick, you need a clean, smooth, dust free and dry surface. For freshly painted walls, allow 1 week for the paint to dry before attaching your wall decal.
- 2 Measure the surface on which you will install the wall decals.
- 3 A great way to do a random patterned wall is to go for a tight spacing up top and then loosen it up as you go down to achieve a cascading waterfall look.
- 4 Carefully peel decals away from the backing paper.
- 5 Position and apply decal to wall. To reposition, slowly peel decal away from the wall, reposition decal and reapply.
- 6 Once the decal is placed, apply pressure with a squeegee or a clean cloth, gently smooth out all bubbles starting from the middle and moving towards edges.
- 7 Optional for non flat surface. Use a heat gun or a hair dryer to better stick the vinyl on textured surfaces. Make sure do not overheat the decal.

Well done!

IT IS SO MUCH FUN TO WORK WITH A SECOND PERSON

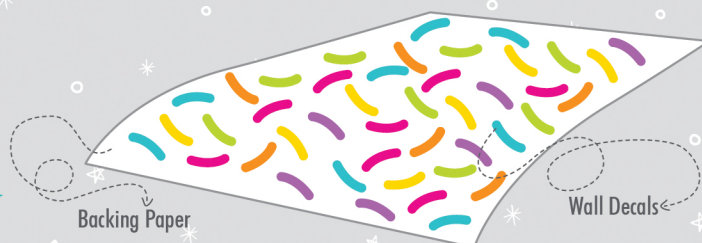

MORE
WALL DECALS AVAILABLE AT
WWW.CLAUVINCK.COM

SELF-STICK REMOVABLE WALL DECAL | WORKS ON MOST SMOOTH FLAT & DRY SURFACE.