

wall decal (with application tape) INSTALLATION INSTRUCTIONS

1 In order for your decal to stick, you need a clean, smooth, dust free and dry surface. For freshly painted walls, allow 1 week for the paint to dry before attaching your wall decal.

2 Put your wall decal into a hard and flat surface, graphic side up. Firmly rub the application tape onto the decal with the help of a squeegee or a credit card.



3 Start at one corner and slowly peel away the paper backing with a rolling action. Make sure the decal remains on the application tape. Some intricate patterns may want to stick to the backing; simply stop peeling, roll back a bit and repress the decal onto the application tape. Be careful and work slowly to avoid damage to your decal.

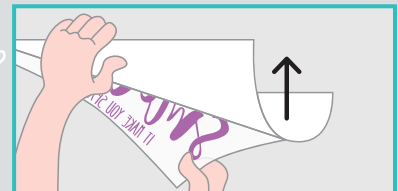

4 Position your wall decal with the application tape on your surface and make sure it is where you want it. Press one edge of the application tape tightly to the surface. With the help of a squeegee or a credit card, start to smooth your decal from the middle to the outside onto your surface.



5 Start at one corner and slowly peel off the application tape at a flat angle. If any parts of the decal sticks to the tape, simply stop pulling, roll back a bit and repress the part onto the surface and continue peeling away, slowly.



6 Optional for non flat surface. Use a heat gun or a hair dryer to better stick the vinyl on textured surfaces. Make sure do not overheat the decal.

Well done!



MORE
WALL DECALS AVAILABLE AT
WWW.CLAUVINCK.COM

SELF-STICK REMOVABLE WALL DECAL | WORKS ON MOST SMOOTH FLAT & DRY SURFACE.

FOR LARGER DECALS IT IS EASIER WITH A SECOND PERSON